

Technical Specification
S-DLP/1/43/FL - Flood
 Complete DALI Self Test
 550mA Stand-Alone Recessed Em LED

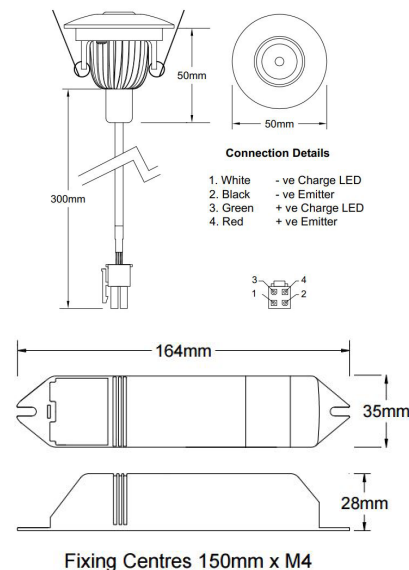
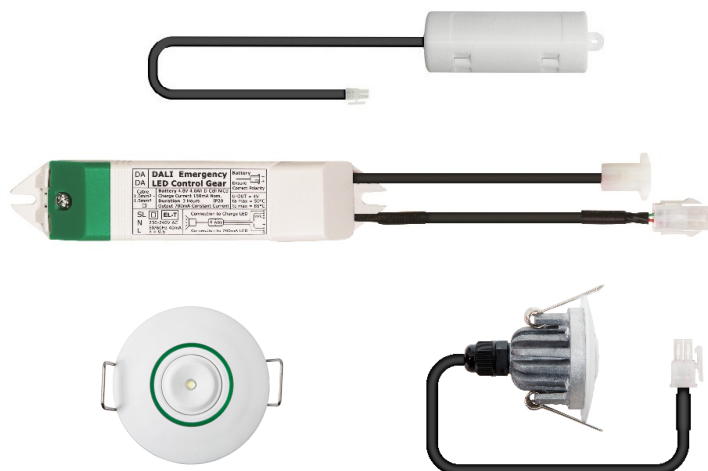

- Suitable for Ceiling Recess Applications.
- Deep Discharge Protection
- Plugs and Leads for Simple Installation
- Ferruled Cables for Mains Input
- Strain Relief Module
- Features LiFePO₄ Extra Long Life Batteries
- 43mm Ceiling Cut-Out
- No Lens - Flood
- 115° Beam Angle
- Features Halo Effect Bi-Colour Charge LED
- DALI 1 Device registered with DiA

The S-DLP/1 DALI Self Test range is supplied with LED/43/FL designed for ceiling recess applications. The non-maintained emergency driver is supplied with strain relief cables and passes through a 43mm aperture.

A 3 hour emergency lighting driver that operates at 550mA in emergency only. This range operates with lithium iron phosphate (LiFePO₄) batteries which not only consume far less power under operation, but last far longer than traditional emergency lighting batteries.

Weblinks:

[Eulumdat File - LED/43/FL @ 550mA](#) [LED/43/FL Conformity](#)
[Installation Instructions .pdf](#)

There are 1 main versions available -

Order Codes

S-DLP/1/43/FL/W Complete 186 Lumen Emergency Solution with 115° Beam Angle LED - IP20 White Bezel RAL 9016

Technical Details:

Mains Supply	230-240V AC 50/60 Hz	Max Ta and Tc	Ta = 40 °C & Tc = 70 °C
Power Rating (Standby)	8mA λ = 0.14	Max Battery Temperature	60 °C
Power Rating (Charging)	16mA λ = 0.46	Battery Discharge Current	700mA
Recharge Period	24-Hours	Discharge Voltage Cut Off	2.5Volts
Battery Size & Type	3.2V 3.8Ah LiFePO ₄	Ingress Protection	Control Gear IP20 (Head IP20)
Charge Current	Dual Rate 0-250mA	Mains Input	1.0mm ² - 1.5mm ²
Protection Class	II	Module Dimensions (LxWxH)	164mm x 35mm x 28mm
Overall Weight (with LED)	0.61Kg	Battery Dimensions (LxØ)	90mm x 35mm